



Exploding Box

This is a lovely gift for family and friends. Perfect for embracing the Christmas Season with 16 double sided pages to journal and attach photos.



Materials

KAISER PRODUCTS:

- Pear Tree Paper Collection
- SB1152 Pear Tree Brads
- Rub-ons -
- SB561 Season's Greetings
- SB560 Christmas Cards
- SB711 Red Rhinestones

OTHER:

- White Gel Pen

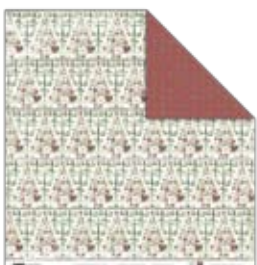

P304 Snowfinch

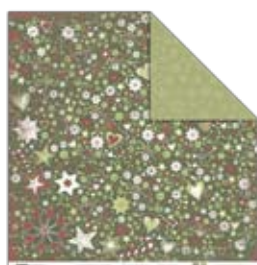

P305 French Hen

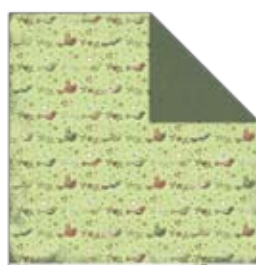

P306 Nightingale



P307 Turtle Dove

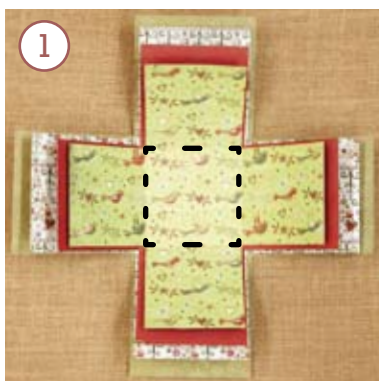

Take 4 sheets of printed paper or cardstock. For this box we have used the Pear Tree Paper Collection.

Cut each sheet to the following sizes and score them as following;

Sheet A - 30.5cm x 30.5cm (12" x 12"), score 10cm (4") in from each side

Sheet B - 28.5cm x 28.5cm (11¼" x 11¼"), score 9.5cm (3¾") in from each side

Sheet C - 26.5cm x 26.5cm (10.5" x 10.5"), score 9cm (3½") in from each side

Sheet D - 25cm x 25cm (9¾" x 9¾"), score 8.5cm (3¼") in from each side

Once you have scored each sheet, carefully cut out the four corner squares.

Now you can start to stick your pieces together. Start with the largest one on the bottom and work up to the smallest (see Photo 1). You only need to put double sided tape in the middle square. You can then embellish and add photos as desired.

To help hold your box together securely, cut two 22cm long and 2cm wide strips. Glue these together to create an approximately 42cm long strip. Fold it four times at 10cm long intervals and glue ends together so that it will fit snugly around the box as shown below.

To make the lid - cut a piece of coordinating paper to 19.5cm x 19.5cm (7¾" x 7¾"). Score along each side of the square, 4cm (1.5") and also 2cm (0.75") in from the edge. The dashed black line in Photo 2 indicates how to do this.

Cut the corners of your lid square along the blue lines shown in Photo 2. Fold along the scored lines and tuck tabs in as shown in Photo 3.

For the bow on top - cut five strips of coordinating papers 15cm x 2.5cm (6" x 1"). Fold each one placing the top left corner around and over the bottom right hand corner (see Photo 4) and adhere in this position. Repeat this with the remaining four pieces and join together with a flower and brad in the centre. Adhere this to the top of your lid. Further decorate your box as desired.

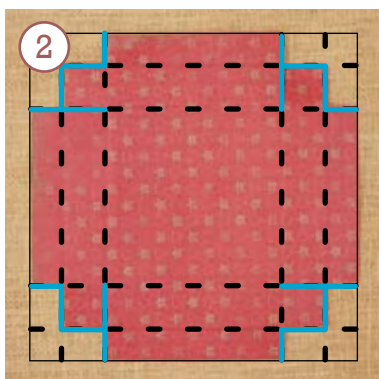

Tip

Add a small bag of chocolate inside the box for an extra surprise gift.